

We Are DESIGN

A division of the Design Proposal Group of Companies.
Design Proposal PTY Ltd T/A We Are Design PTY Ltd



Table Of CONTENTS

Our Motto, About, Incorporation 03

Bankers & Attorneys 03

Our Mission, Our Environmental Policy 04

Professional & Technical Staff 05

Client References 05

Our Experties 06

Current & Completed Projects 07

Commercial & Industrial Projects 08

Interior Design 11

Hospitality Projects 10

Monuments 16

Residential Projects 17





Our MOTTO

"Vision made reality through creative and innovative architectural design solutions."

Incorporation

WE ARE DESIGN is a firm that provides consultancy services in Architecture and related services. It was incorporated in the Republic of Botswana on 16th December 2015, registration number CO2015/20395

Bankers & Attorneys

Our bankers are First National Bank Botswana, Kgale Branch, Gaborone, and our attorneys are Babusang Attorneys of Unit 29 of Kgale Mews Millennium Park.

About US

WE ARE DESIGN was birthed in 2015 out of the need to fill the gap in the Architectural Consultancy service sector. We pride ourselves in being able to provide tailor made design solutions which are a response to the client's needs. A research based approach is taken in which we take time to educate ourselves with the problem at hand to be better equipped to creatively provide innovative design solutions. Our designs are not only tailored to meet the client's needs, they are also a timeless distinction in this highly competitive world.

Directors & SHAREHOLDERS



The director of Design Proposal (PTY) Ltd is Tonderai T W Ruwambara, is a holder of a Masters in Architecture degree. As Managing Director, Mr. Ruwambara is responsible for the management and marketing of Design Proposal as well as overseeing all architectural design and project management services provided by the firm. Mr Ruwambara is also responsible for overseeing and providing guidance to all Architects in the Firm on all aspects of architectural design, drawing work and documentation. In addition to the above, Mr. Ruwambara and his team has a responsibility to search out new technologies and innovative solutions to ensure provision of high quality service for clients and to maintain Design Proposal (Pty) Ltd at the forefront of the industry.



Our MISSION

- We make clients happy by delivering the highest quality value architectural and professional services.
- Be the company of choice by our clients and employees
- Build a sustainable regional and internationally recognized architectural practice.
- Provide career growth and wealth creation opportunities for employees

Our Staffing And LOGISTICAL POLICY

The staff and contract personnel are selected on the basis of experience, talent and ability, dedication and a broad outlook on all aspects of the construction industry and cultural community.

“Wherever possible, preference is given to Botswana Citizens when recruiting and employing staff.”

Our Environmental POLICY

Over the past few years the idea of sustainable design has become a permanent part of our thoughts and now it has become reality through new approaches to architectural conception and construction. The approach of Design Proposal is not merely qualitative, it also forms part of a carefully thought out economic process.

- **Integration into the Environment:** A sustainable product is only viable if it is integrated into its settings, in the modest sense: Historical aesthetics and social integration are observed as conceptions that respect the mixture of functions within the urban setting.
- **The Materials:** Our architects are very conscious of their responsibility in selections of materials and energy systems. Projects pay special attention to the choice of construction material throughout their whole life-cycle from manufacture to potential recycling.

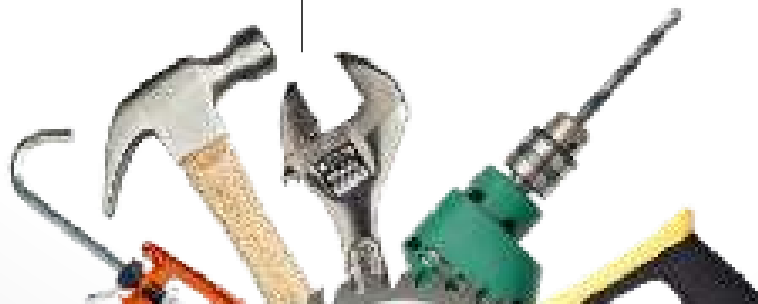

Word from the DIRECTOR



TONDERAI T W RUWAMBARA

Managing Director

Bsc Arch.S (Hons), Msc.Arch.(Prof)
Pr Arch. MARC.bw

"We Are Design is a vibrant Architectural Practice which has evolved to become the Embodiment of Creativity. We are creative problem solvers dedicated to a hands-on approach that brings a passion for craftsmanship into all phases of our projects. Our mantra is to ensure that our Clients get more than they expected or envisaged. Projects are executed with a commitment to quality design with a disciplined approach to project constraints and Client's needs. Emphasis is placed on providing the required and appropriate services as determined by each individual projects needs."

"We creatively use our spectrum of skills and provide clients with total solutions, our ideas are never static, and constantly evolve to adapt various needs of the clients. We approach all problems with energetic dynamism and are passionate about our works and the service we provide."



“

OUR MANAGING DIRECTOR
TONDERAI T W RUWAMBARA HAS
OVER 15 YEARS OF EXPERIENCE IN
THE PROFESSION WITH A DIVERSE
RANGE OF PROJECT TYPOLOGIES. HE
IS A HOLDER OF A MASTER'S
DEGREE IN ARCHITECTURE AND IS A
MEMBER OF THE ARCHITECTS
REGISTRATION COUNCIL OF
BOTSWANA REG NO: 01230325

”

Our EXPERTIES

- **ARCHITECTURE DESIGN**
- INTERIOR DESIGN
- LANDSCAPE DESIGN
- PLANNING & URBAN DESIGN
- ANIMATION & VISUALISATION



Residential PROJECTS

HOUSE JAZIRE

PLOT 17926 Broadhurst Gaborone

The Existing house was remodelled to give a contemporary look and Feel. Images of the Before and After show how we took what was ailing and injected life into the structure.

- ARCHITECTURE DESIGN
- INTERIOR DESIGN
- PLANNING & URBAN DESIGN
- **RENOVATIONS**
- ANIMATION & VISUALISATION

BEFORE



AFTER



Residential PROJECTS

HOUSE KAUNDA

AMAVEL ESTATES ZAMBIA

Set on a 2 Hectare piece of Land in Zambia. The objective was to design a Contemporary Farm House Style Residence. The House was designed to fit in the landscape and blend with nature. It features exposed trusses and high ceilings.

- ARCHITECTURE DESIGN
- INTERIOR DESIGN
- **PLANNING & URBAN DESIGN**
- LANDSCAPE DESIGN
- ANIMATION & VISUALISATION



Residential PROJECTS

HOUSE MOREMONG

PLOT 5568 PARTIAL GABORONE

The House is set in the heart of Gaborone (Partial) with full visibility from major traffic light. The Residence is a modern home which is a composition of CUBES that are arranged seamlessly giving a contemporary symphony of spaces.

- ARCHITECTURE DESIGN
- INTERIOR DESIGN
- **PLANNING & URBAN DESIGN**
- LANDSCAPE DESIGN
- ANIMATION & VISUALISATION



Residential PROJECTS

HOUSE NGONI

PLOT 18463 PHASE 2 GABORONE

The unique aspect of the design is that the Plot was only 400sqm. The task was to design a contemporary house with 4 bedrooms and all the amenities accordingly. A slim approach to the entrance as well as open plan layout accommodated all the requirements with enough space for a carport or garage option as well.

- ARCHITECTURE DESIGN
- INTERIOR DESIGN
- **PLANNING & URBAN DESIGN**
- LANDSCAPE DESIGN
- ANIMATION & VISUALISATION



Residential PROJECTS

HOUSE SHAMBAHWETA

PLOT 512 NOTWANE

Set on a 1 Hectare piece of Land in Notwane. The objective was to design a Contemporary Farm House Style double storey Residence. The House was designed to fit in the landscape and blend with nature. It features exposed trusses and Laser cut steel sun visors which double up as sun shading devices as well as aesthetic features

- ARCHITECTURE DESIGN
- INTERIOR DESIGN
- **PLANNING & URBAN DESIGN**
- LANDSCAPE DESIGN
- ANIMATION & VISUALISATION



Residential PROJECTS

HOUSE SITHOLE

ZIMBABWE

This is a modern house set in an affluent neighbourhood in GWERU ZIMBABWE. The Task was to design a modern house that has 2 entertainment areas, one in front and the other in the rear. The design was to also have a farmhouse feel.

- ARCHITECTURE DESIGN
- INTERIOR DESIGN
- **PLANNING & URBAN DESIGN**
- RENOVATIONS
- ANIMATION & VISUALISATION



Residential PROJECTS

HOUSE ALFRED

Completed in 2018 and set in Block 10. This house was a upgrade from a previous design by another Architect, which the Client was not pleased with and the request was to modernise the design of which the Construction had already started. We infused projecting elements that define specific areas of the house, thus harmonising the design.

- ARCHITECTURE DESIGN
- INTERIOR DESIGN
- PLANNING & URBAN DESIGN
- LANDSCAPE DESIGN
- ANIMATION & VISUALISATION



Good designs,
the kind that
resonate and endure,
require patience.

NOT JUST WITH THE
PROCESS, BUT WITH
YOURSELF.



Low Cost Multi Residential PROJECTS

LOW COST
MULTI-RESIDENTIAL
PROJECTS

2 BED DUPLEX

- ARCHITECTURE DESIGN
- INTERIOR DESIGN
- **PLANNING & URBAN DESIGN**
- LANDSCAPE DESIGN
- ANIMATION & VISUALISATION



Low Cost Multi Residential PROJECTS

LOW COST
MULTI-RESIDENTIAL
PROJECTS

1 BED LOW COST UNIT

- ARCHITECTURE DESIGN
- INTERIOR DESIGN
- **PLANNING & URBAN DESIGN**
- LANDSCAPE DESIGN
- ANIMATION & VISUALISATION



Low Cost Multi Residential PROJECTS

LOW COST
MULTI-RESIDENTIAL
PROJECTS

2 BED LOW COST UNIT

- ARCHITECTURE DESIGN
- INTERIOR DESIGN
- **PLANNING & URBAN DESIGN**
- LANDSCAPE DESIGN
- ANIMATION & VISUALISATION



Multi Residential PROJECTS

BDF RESIDENTIAL COMPLEX IN MOGODITSHANE

Set in Mogoditshane near BDF. A combination of 2 and 3 bed units were arranged into blocks with their own secure parking. The hierarchy is such that the 3 bed units are for higher ranking officials and the 2 beds for lower ranking officials.

- ARCHITECTURE DESIGN
- INTERIOR DESIGN
- PLANNING & URBAN DESIGN
- LANDSCAPE DESIGN
- ANIMATION & VISUALISATION



TYPICAL UNIT 'A' FLOOR PLAN
SCALE: 1:100

PLOT 25222

Number of 2 bed Units 22 units
Area of Unit 70 sqm each
Number of stories 2 Storeys

PLOT 33227

Number of 2 bed Units 24 units
Area of Unit 70 sqm each
Number of stories 2 Storeys

Typical Unit 'A' Plan

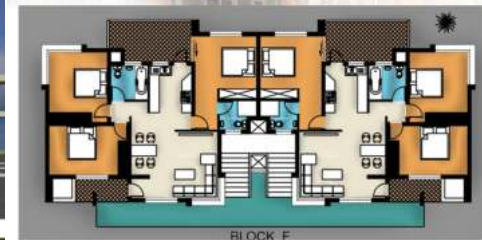

PLOT 25222 and 33227 each

Number of 3 bed Units 6 units per plot
Area of Unit 90 sqm each
Number of stories 3 Storeys
Lift Provided

Typical Unit 'B' Plan



PLOT 25222 and 33227 each

Number of 3 bed Units 6 units per plot
Area of Unit 90 sqm each
Number of stories 3 Storeys
Lift Provided

Typical Unit 'B' Plan

Multi Residential PROJECTS

MOGODITSHANE 2 BEROOM COMPLEX

Set in Mogoditshane near Pula Spar. This was an opportunity to create an aesthetically pleasing complex which would become the focal point of the area. There will be 20 2 bed units. The Brief was to ensure that the complex can be converted into a self-catering lodge at a later stage. This was achieved by making all rooms fully ensuite with space for a laundry and dining.

- ARCHITECTURE DESIGN
- INTERIOR DESIGN
- **PLANNING & URBAN DESIGN**
- LANDSCAPE DESIGN
- ANIMATION & VISUALISATION



Multi Residential PROJECTS

TOWNHOUSES IN HARARE

ZIMBABWE

Harare Is currently expanding with high demand for high end Townhouses. The Project is set in Good Hope on 2100sqm land. The Town Houses are ultra-modern with 3 bedrooms on the 1st floor. Each unit has a pool and garden at the back.

- ARCHITECTURE DESIGN
- INTERIOR DESIGN
- **PLANNING & URBAN DESIGN**
- LANDSCAPE DESIGN
- ANIMATION & VISUALISATION





**A room should
never allow the
eye to settle in
one place.**

Commercial & INDUSTRIAL

CHINA MALL MOGODITSHANE

Located in Mogoditshane at the 4 way Traffic lights. The Mall is an obvious attraction hence the emphasis on bright colours and pegola steel visors that add to the detail of the Mall. The Mall consists of an Anchor Store and 6 smaller stores. The Lay out is a L Shape hugging the intersection

■ ARCHITECTURE DESIGN

PLANNING & URBAN DESIGN
INTERIOR DESIGN
ANIMATION & VISUALISATION
LANDSCAPE DESIGN



Commercial & INDUSTRIAL

MASIKA MALL

Located in Kopong. The Mall draws its identity from the Masama Coal Mine. The colour scheme consists of shades of grey which is a spectrum of coal dust. The Structural design follows an exo-skeletal approach. The Mall consists of an Anchor Store at the centre axis surrounded by smaller stores and a standalone Hardware and Filling Station.

■ ARCHITECTURE DESIGN

PLANNING & URBAN DESIGN
INTERIOR DESIGN
ANIMATION & VISUALISATION
LANDSCAPE DESIGN



Commercial & INDUSTRIAL

BANGO TRADING OFFICE BLOCK (PLOT 70714 PHAKALANE INDUSTRIAL GABORONE)

Located in Phakalane Industrial the Project consisted of a double storey Office Block as Phase 1 and then the Warehouses at the rear which are detached. The design centres on Symmetry as the main design intent. This gives a balance which is easy on the eye and appeals to the corporate identity of Bango Trading.

- **ARCHITECTURE DESIGN**
- PLANNING & URBAN DESIGN
- INTERIOR DESIGN
- ANIMATION & VISUALISATION
- LANDSCAPE DESIGN



Interior Design & FITOUT

RHAPSODY SEBELE

Completed in 2021. The design was brand oriented. The commission was design and build working closely with the brand custodians in South Africa. The successful project has resulted in a much sought out luxury dining and lounge entertainment

ARCHITECTURE DESIGN
INTERIOR DESIGN
PLANNING & URBAN DESIGN
LANDSCAPE DESIGN
ANIMATION & VISUALISATION



Interior Design & FITOUT

SHRENUJ

Forevermark sought to partner with Shrenuj diamonds in 2016. The task was to design a 3m x 3m space at the SSK Airport. The Design concept was based on the clarity of a crystal. Clean and elegant with a hint of prestige.

- ARCHITECTURE DESIGN
- **INTERIOR DESIGN**
- PLANNING & URBAN DESIGN
- LANDSCAPE DESIGN
- ANIMATION & VISUALISATION



Interior Design & FITOUT

VISION SPORT STORE

Vision Sport has become a leader in the Sport apparel and equipment space. The task was to design a space that reflects the future of the brand and a typical roll out of future store. By using simple yet elegant elements we created a space that was both futuristic yet simple to manoeuvre in.

- ARCHITECTURE DESIGN
- **INTERIOR DESIGN**
- PLANNING & URBAN DESIGN
- LANDSCAPE DESIGN
- ANIMATION & VISUALISATION



Hospitality PROJECT

PAJE LODGE

Set in Paje near the Rhino Sanctuary. The land is divided by a river which cuts across, thus becoming the main focal point of the design. Blending in with nature was the objective however the Clients requirements were to use a different material other than thatch. Chromodeck coloured green to blend in with the lush environment.

- ARCHITECTURE DESIGN
- PLANNING & URBAN DESIGN
- INTERIOR DESIGN
- ANIMATION & VISUALISATION
- LANDSCAPE DESIGN



Corporate Social Responsibility

SIR & LADY MASIRE GRAVE SHELTER & HEADSTONE

This Project came as an honor to our Team. Our task was to design a Grave Shelter and Headstone for the Late President Sir Ketumile Masire and his dear Wife Lady Gladys Masire.

The Concept was to create a Timeless work of Art which is sculporal in nature and self maintaining to cover the two existing graves.

- ARCHITECTURE DESIGN
- INTERIOR DESIGN
- PLANNING & URBAN DESIGN
- LANDSCAPE DESIGN
- ANIMATION & VISUALISATION

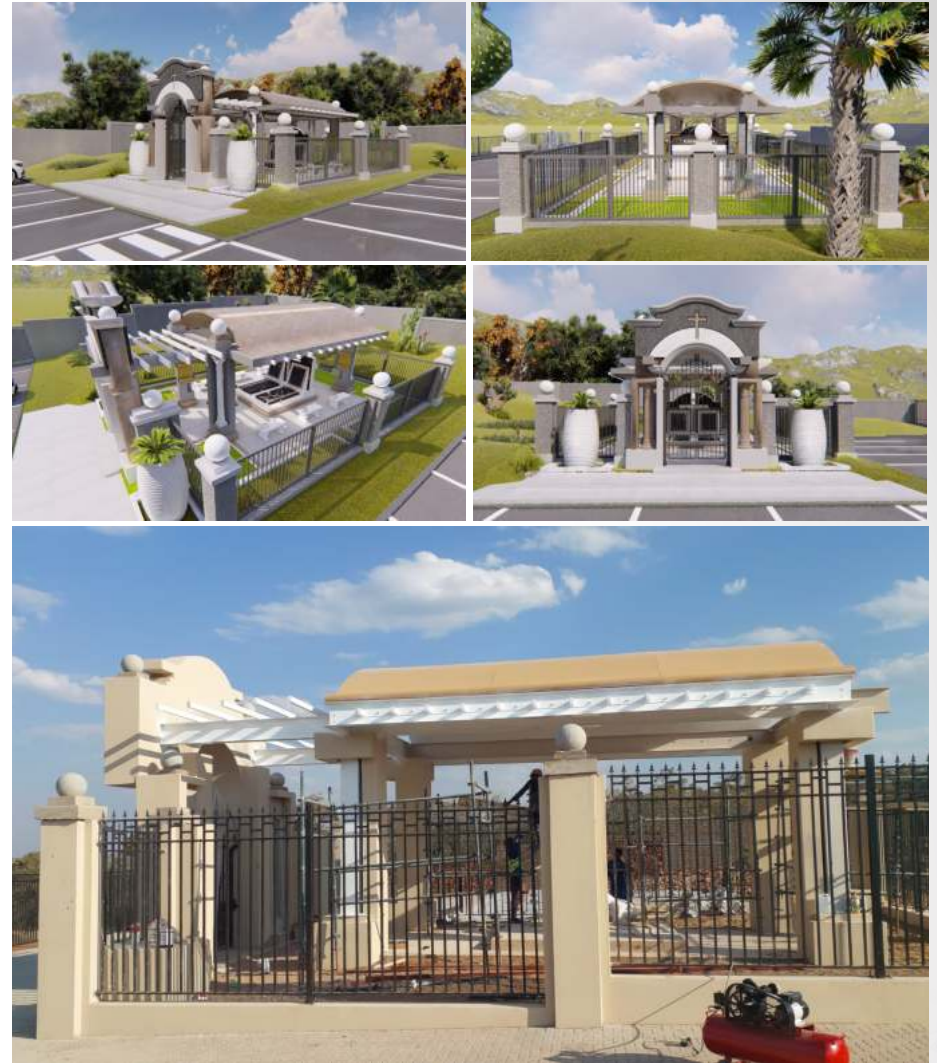

Client REFERENCES

REFERENCES FOR CORPORATE CLIENTS

ORGANISATION	CONTACT	TELEPHONE NUMBER
KGK DIAMONDS BOTSWANA PTY LTD 	SIDDHARTH GOTH	+26775199501
RTT Botswana Pty Ltd 	John and Jean Mcpartland	+26776920530
SIGNET DIRECT DIAMONDS SOURCING BOTSWANA 	SHANE FOX	+26772307770
BANGO TRADING PTY LTD 	MOFFAT JAMES	+267 3180276/ 2419412
DIACORE BOTSWANA PTY LTD 	ROZANNE ZONDAGH	+267 390 7640 / 6/ 9
RHAPSODY 	PAUL CHAMPANE	+267754019010

SEBELE PRIVATE CLINIC 	DR. MUNETSI	+26772308224
KUBLA KHAN 	SEFALANA MODISI	+26773912260
ABOUT PHYSIOTHERAPY PTY LTD 	PASSMORE SHAMBAHWETA	+26772839759
FURNMART BOTSWANA 	LEKANG LEKANG	+26772957897

ITUMELENG MOHOLO (PLOT 5568 PARTIAL GABORONE)	+26772807998
MASIMBAASHE MUNETSI (PLOT 43080 PHAKALANE)	+26772308224
SEFALANA MODISI (PLOT 37268 BLOCK 8 GABORONE)	+26773912260
MOFFAT JAMES (PLOT 69702 SETHLOA GABORONE)	+267 3180276
PASSMORE SHAMBAHWETA (LOT 512 NOTWANE)	+26772839759

WE ARE DESIGN has developed many relationships with clients for both one off projects and repeat commissions. We list below our major clients who have generally been involved with repeat commission projects. This is ultimately the test of a satisfied client.

 PO. Box 401954 Broadhurst Gaborone

 +(267) 74 118 673

 tonde@we-are-design.africa

 www.we-are-design.africa



A division of the Design Proposal Group of Companies.
Design Proposal PTY Ltd T/A We Are Design PTY Ltd

